

Quick Start Guide

Medium Group PA System



Initial Setup

- 1 Set up stands by adjusting knobs, separating tripod legs and extending height
- 2 Place speakers on stands, and position speaker units between the audience and the presenter

Connections & Settings

- 3 Connect AC Power Cord to the Power Inlet and an electrical outlet
- 4 Set Volume controls to minimum and Tones controls to middle
- 5 Switch POWER button to ON

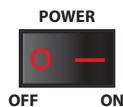

Using the Wireless Microphone

For Handheld Microphone:

- Turn microphone ON by sliding switch all the way up until **red line** is displayed
- To MUTE microphone, slide switch until **green line** is displayed



For Lapel Microphone:

- Clip lapel mic to shirt collar or other piece of clothing near source of audio
- Flip power switch on top of belt-pack transmitter to ON



- 6 Adjust Wireless Volume and Tones levels accordingly



Quick Start Guide

Medium Group PA System



Troubleshooting

● *If the speakers and microphone do not sync properly:*

Ensure that the *Wireless 1* knob on back of speakers is set to **1** and the Channel Selector inside the battery compartment of the microphone is also set to **1** (this is the default factory setting). To check the mic setting, simply unscrew the battery case. (For the lapel mic, the Channel Selector is on the side.)

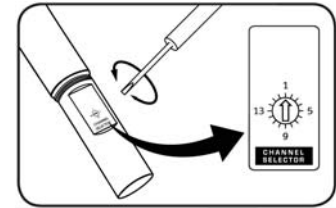

If using multiple wireless microphones, you will need to set the *Wireless 2* knob to **2** on the back of each speaker, and also ensure that the Channel Selector of the second microphone is set to **2**

● *If the microphone fades in and out, or does not turn on, you may need to replace the batteries. To do so:*

- Unscrew the battery cover on bottom of microphone
- Replace old batteries with 2 fresh AA batteries
- Replace battery cover and tighten firmly

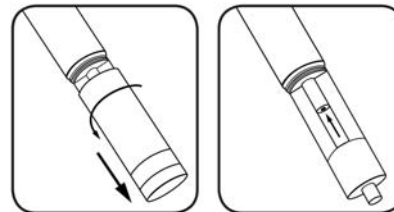

For lapel microphones, open the cover on the belt-pack transmitter, replace the batteries, and slide the cover back into place

● *If the sound is distorted, you may need to:*

- Lower the volume
- Reposition the speakers to avoid feedback (correct placement is with speakers in front of microphone)
- Replace audio cables (*please call us if this is the case!*)

If you encounter any problems whatsoever, please call us at 1-877-633-8866. We're more than happy to help!