

Quick Start Guide

Laptop Computer



Initial Setup

- 1 Connect the power cable to the AC adapter
- 2 Plug the AC adapter cable into the power connector on back of laptop
- 3 Plug the power cable into an electrical outlet
- 4 Open the laptop by pushing in on the "Compaq" button and lifting the screen

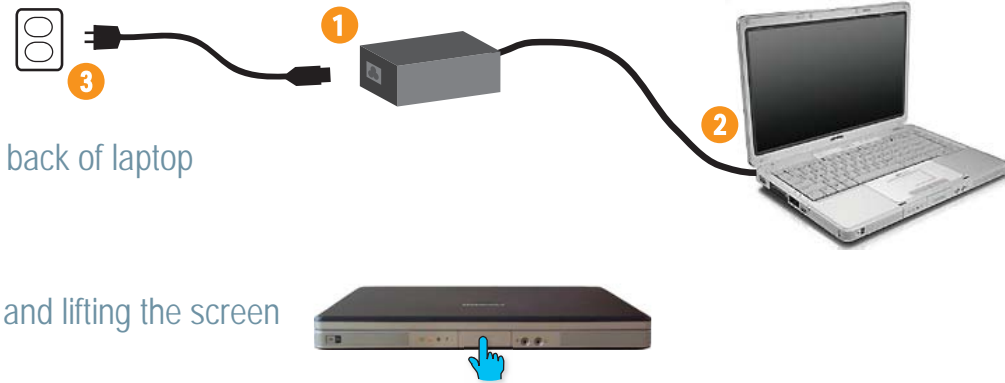

Getting Up and Running

- 5 Turn ON the laptop by pressing the power button  located above the keyboard
- 6 When the computer boots up, you can find shortcuts to all the major programs at the bottom of your desktop
- 7 If connecting to a wireless network, the computer should automatically detect a signal in range.

Note: If a signal is not detected, press the "wi-fi button" above the keyboard. Once the button is illuminated, your laptop should connect momentarily.



Installing Software

- 8 If you need to install software, insert your disc in the CD drive and the **Installation Wizard** will guide you through the setup process
- 9 If the Installation Wizard does not appear, follow these steps to get started:
 - Go to the START menu (located in the lower left-hand corner)
 - Click RUN
 - Select BROWSE
 - From the drop-down menu, find your disc (D:) and click to open it
 - Navigate to the appropriate file (usually "install" or "setup") and press OPEN

If you encounter any problems whatsoever, please call us at 1-877-633-8866. We're more than happy to help!